



Titrating the EMA appliance

The **EMA** oral appliance from EMA-Sleep, Inc. increases airway space by advancing the mandible using interchangeable elastic straps. EMA elastic straps come in **9 different lengths** (see figure A), and **4 different strengths** (see figure B). The shorter the EMA elastic strap, the farther the mandible is advanced (see figure C). **36 different straps** allow for the most effective repositioning with maximum comfort.

9 different lengths allow for 1 mm advancement of the mandible

Figure A

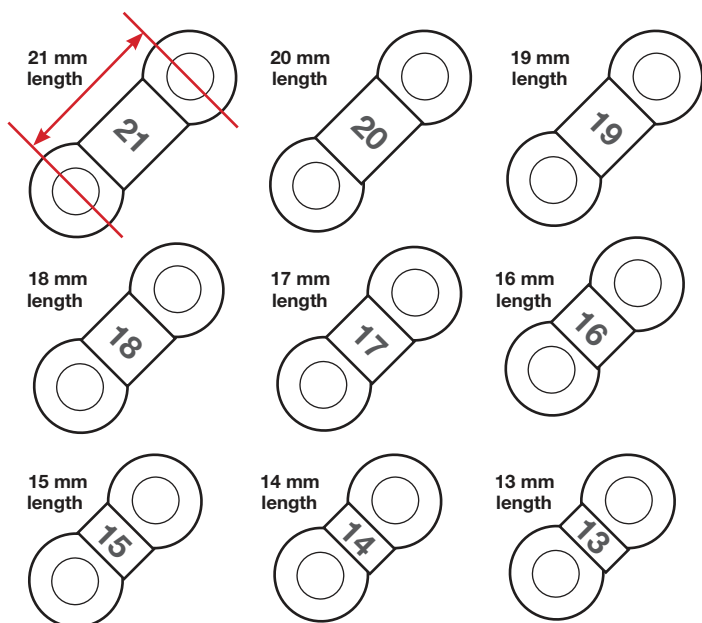

Each EMA elastic strap comes in 4 different strengths, indicated by color.

Figure B

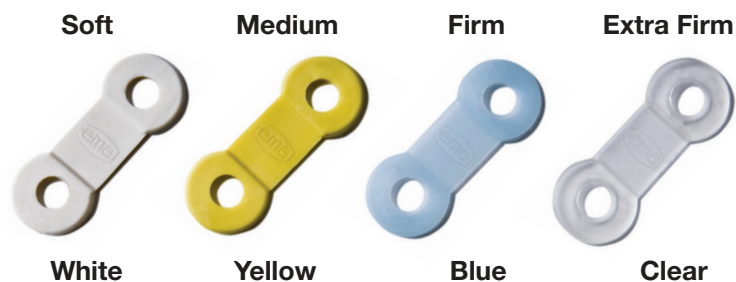

EMA elastic straps are 100% latex free.



DISTRIBUTED BY
EMA-Sleep, Inc.
800-588-7898
ema-sleep.com

EMA® is a trademark of frantz design inc.
US Patent Numbers: 6,109,265; D611,153 & Patent Pending



The shorter the EMA elastic strap, the farther the mandible is advanced.

Figure C

EMA buttons are 27 mm apart*

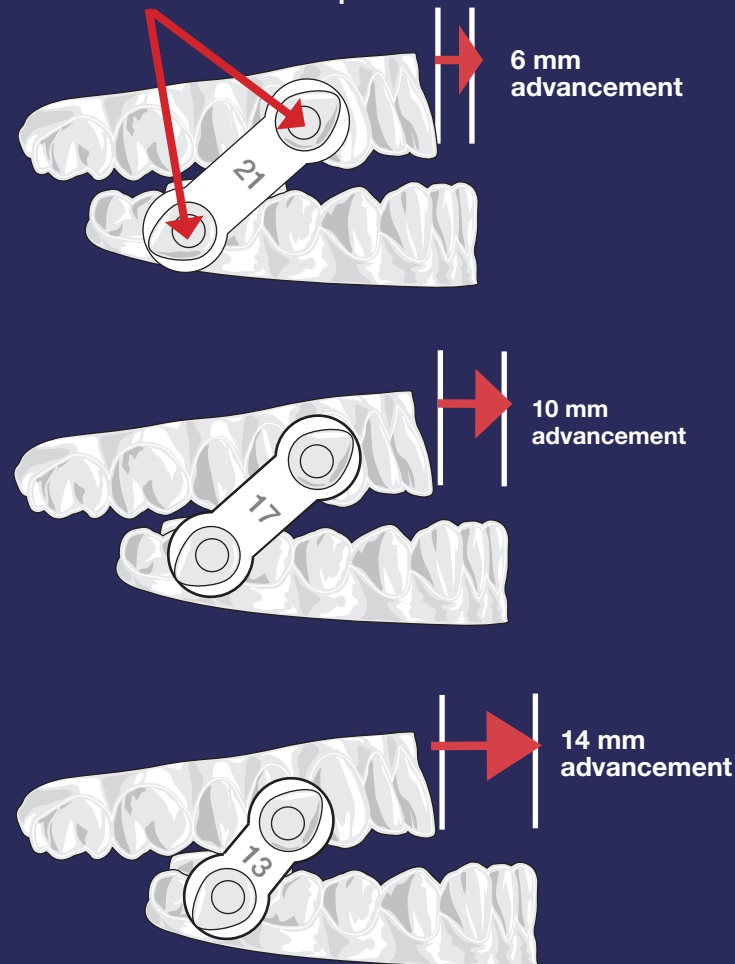

DISTANCE BETWEEN EMA BUTTONS

	27 mm	25 mm
EMA® STRAP LENGTH	AMOUNT OF ADVANCEMENT	
21 mm	6 mm	4 mm
20 mm	7 mm	5 mm
19 mm	8 mm	6 mm
18 mm	9 mm	7 mm
17 mm	10 mm	8 mm
16 mm	11 mm	9 mm
15 mm	12 mm	10 mm
14 mm	13 mm	
13 mm	14 mm	

*EMA-Sleep, Inc. recommends a distance between the buttons of 27 mm in the centric position. If the patient's range of mandibular advancement is limited to 9 mm or fewer, a distance of 25 mm distance is recommended.

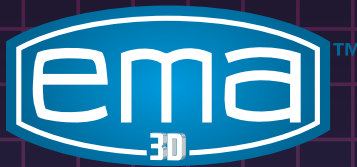

SIMPLICITY WITH COMFORT

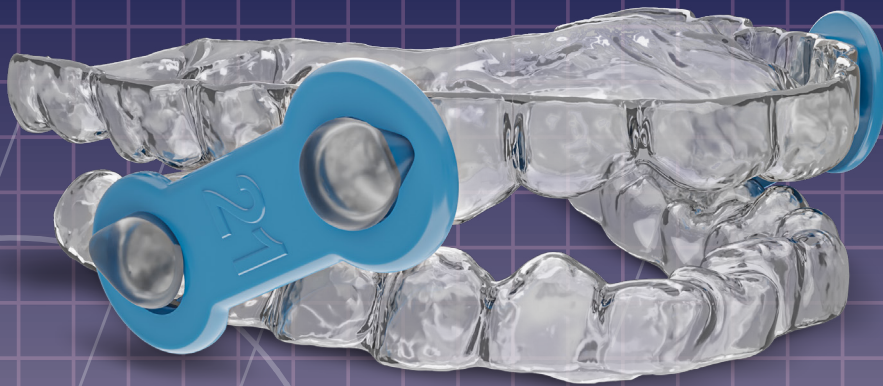

PROVEN SLEEP TECHNOLOGY

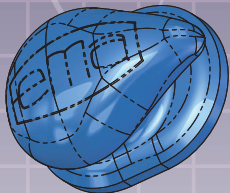

Patented, custom design resulting in comfort and effectiveness

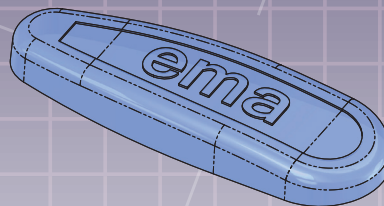

Minimal profile and anatomically correct occlusal pad to maximize oral cavity volume



9 different lengths allow for 1 mm advancement of the mandible

- Durable, biocompatible and colorless finish
- Utilizes proprietary 3D print resin technology for added flexibility and patient comfort