



# Titration the EMA appliance

The **EMA** oral appliance from EMA-Sleep, Inc. increases airway space by advancing the mandible using interchangeable elastic straps. EMA elastic straps come in **9 different lengths** (see figure A), and **4 different strengths** (see figure B). The shorter the EMA elastic strap, the farther the mandible is advanced (see figure C). **36 different straps** allow for the most effective repositioning with maximum comfort.

**9 different lengths allow for 1 mm advancement of the mandible**

**Figure A**

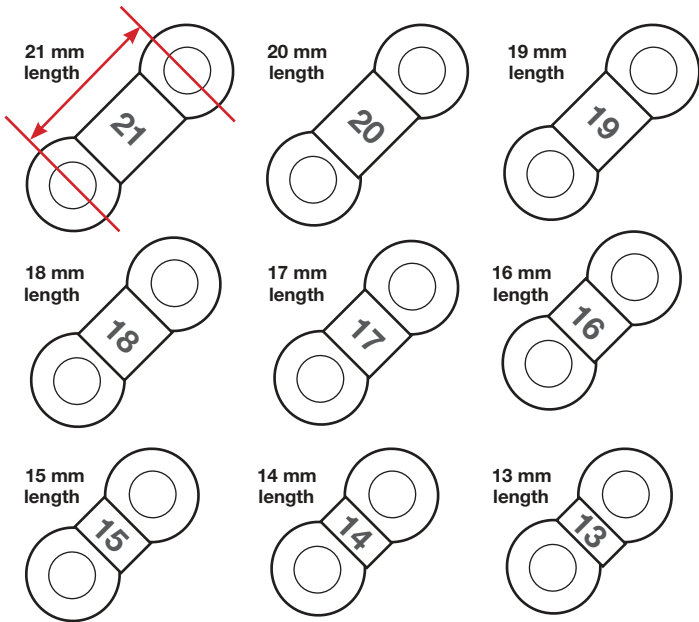

**Each EMA elastic strap comes in 4 different strengths, indicated by color.**

**Figure B**

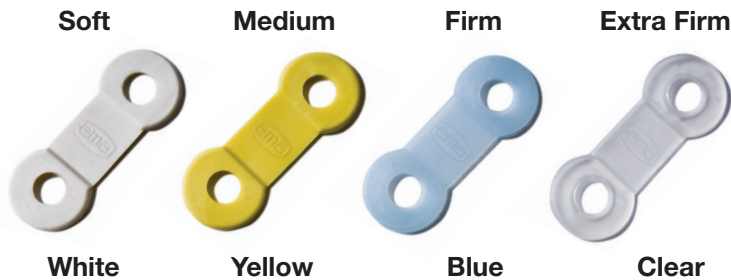

**EMA elastic straps are 100% latex free.**



DISTRIBUTED BY  
**EMA-Sleep, Inc.**  
800-588-7898  
ema-sleep.com

EMA® is a trademark of frantz design inc.  
Broadly covered by U.S. and International patents.



**The shorter the EMA elastic strap, the farther the mandible is advanced.**

**Figure C**

EMA buttons are 27 mm apart\*

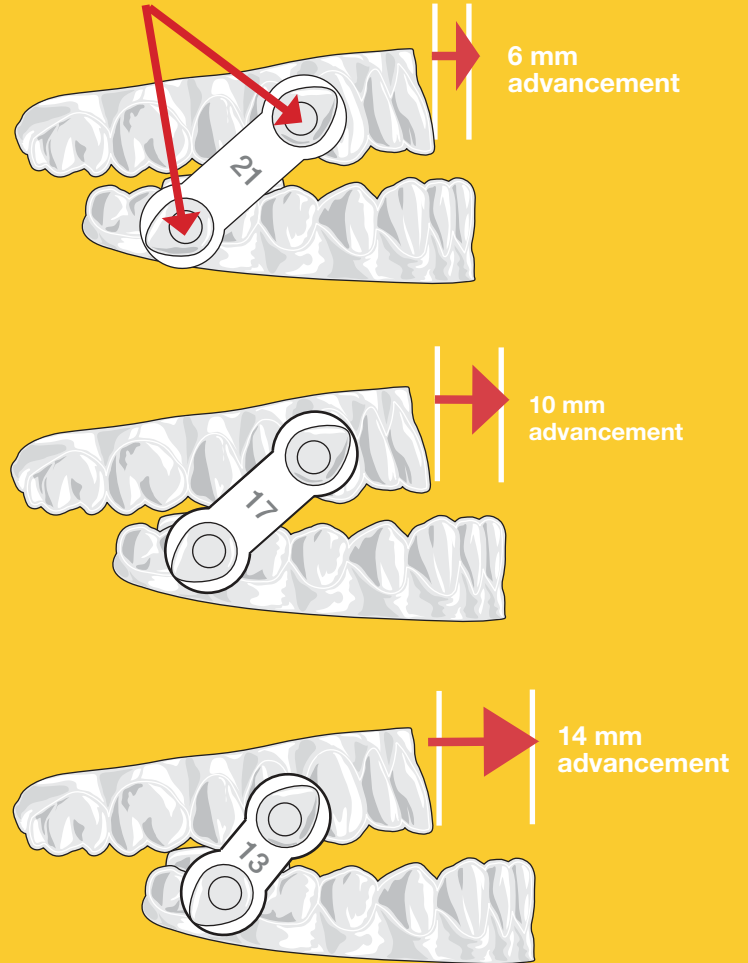

**DISTANCE BETWEEN EMA BUTTONS**

27 mm      25 mm

EMA® STRAP LENGTH	AMOUNT OF ADVANCEMENT	
21 mm	6 mm	4 mm
20 mm	7 mm	5 mm
19 mm	8 mm	6 mm
18 mm	9 mm	7 mm
17 mm	10 mm	8 mm
16 mm	11 mm	9 mm
15 mm	12 mm	10 mm
14 mm	13 mm	
13 mm	14 mm	

\*EMA-Sleep, Inc. recommends a distance between the buttons of 27 mm in the centric position. If the patient's range of mandibular advancement is limited to 9 mm or fewer, a distance of 25 mm distance is recommended.



# SIMPLICITY EXEMPLIFIED



## PROVEN SLEEP TECHNOLOGY

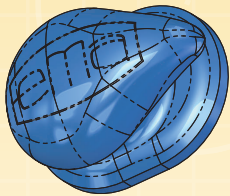

Patented, custom design resulting in comfort and effectiveness

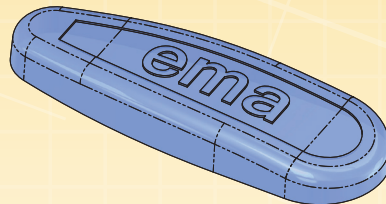

Minimal profile and anatomically correct occlusal pad to maximize oral cavity volume



9 different lengths allow for 1 mm advancement of the mandible

- Clinically proven to be effective since 1993
- Improves nighttime breathing by advancing the mandible to maximize airway space
- 36 different strap options allow for effective repositioning with maximum comfort
- Thin, biocompatible material
- FDA Cleared